

ANSI/SPRI/FM4435/ES-1 TEST PRESSURES UP TO 247 PSF (HORIZONTAL)

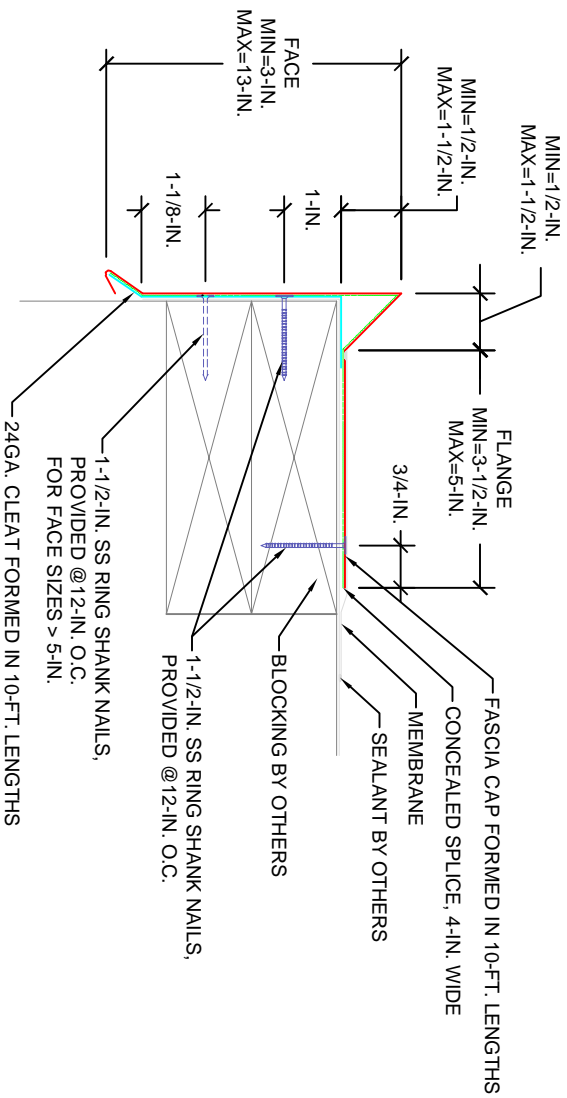

FOR MASONRY APPLICATIONS, PLEASE CONTACT OMG.
 CONTACT OMG FOR APPROPRIATE RECOMMENDATIONS NEEDED TO MEET/EXCEED
 ANSI/SPRI/FM4435/ES-1 DESIGN CRITERIA

APPLICATIONS:
 MOD BIT
 BUR

SIZES:
 SEE DRAWING

NOTES:
 1-REFER TO ROOF MEMBRANE MANUFACTURER FOR
 THEIR APPROVED INSTALLATION DETAIL.
 2-TESTED IN ACCORDANCE WITH ANSI/SPRI/FM4435/ES-1.

ANSI/SPRI/FM4435/ES-1 TESTED



Approved

		MBED-G FASCIA
MADE IN CHINA BY: F.L. APPRO. BY: KCP	DATED: 02/20/2020 DATE: 02/20/2020	SCALE: NOT TO SCALE
OMG Inc. A Commerce Way 828-676-1700 www.omgroofing.cc		SHEETS 1 OF 1